

Hyatt Regency Greenville

ADDRESS 220 North Main Street, Greenville, SC 29601, USA
PHONE 864-235-1234 SALES FAX 864-370-9204
WEB www.greenville.hyatt.com



ACCOMMODATION

- 328 guestrooms, including nine suites / parlors, 22 upgrade accommodations, 170 kings / queens, 147 double / doubles, 52 Hyatt Business Plan®, 12 accessible rooms, and 323 non-smoking rooms

All accommodations offer:

- Hyatt Grand Bed™
- 32-inch LCD flat screen television with remote control, cable movie channels, and in-room pay movies
- Wireless high-speed Internet access
- Television access to internet, games, digital music, and movies
- Telephone with voice mail, message light, and data port
- Video account review, video checkout
- Audio checkout
- Individual climate control
- Electronic door lock
- Full bath amenities
- Turndown service available on request
- Iron / ironing board
- AM/FM alarm clock
- Hair dryer
- Coffee maker with complimentary coffee

SERVICES & FACILITIES

- 1-800-CHECK-IN®
- Web-in/PDA check-in
- Check-in kiosk
- Hyatt Fast Board™
- Hyatt E-Concierge
- Assistive devices for persons with disabilities
- Full-service business center
- Laundry / dry cleaning
- In-room dining
- Valet parking
- Covered parking
- Multilingual staff
- Currency exchange
- Safe-deposit boxes at front desk
- Soda, ice machines
- Gift shop

RESTAURANTS & BARS

- Provenica—Continental cuisine served in casually elegant surroundings
- Commons Bar—lighter fare and cocktails
- In-room dining

CONFERENCES & BANQUETS

- More than 24,000 square feet of flexible function space, 4,000 square feet of prefunction space, and 14,381 square feet of exhibit space
- Grand Regency Ballroom offers the most meeting space in the city and includes direct vehicle access
- Executive Boardroom features multiple data ports, communications anteroom, and executive seating
- Atrium lobby offers impressive space for prefunction and theme receptions and dinners
- Ample breakout rooms available to accommodate up to 21 separate sessions
- 17 meeting rooms offer individual controls for heat/AC, sound, music, telephones, multiple electrical / microphone outlets, special lighting effects and 110V single-phase and 220V single-phase electricity
- High-speed Internet access; T1 lines in all meeting rooms
- Separate registration area
- Off-premise catering available
- Onsite audiovisual company

RECREATIONAL FACILITIES

- Outdoor pool (seasonal)
- Sundeck
- 24-hour Hyatt Stay Fit gym, with Life Fitness® treadmills and elliptical crosstrainers
- Jogging paths
- Award winning golf courses nearby, with special arrangements for hotel guests

POINTS OF INTEREST

- Main Street restaurants
- Galleries and clubs
- BI-LO Sports and Entertainment Center
- Peace Center for Performing Arts
- Greenville Art Museum
- Reedy River Falls Historic Park
- West End Market
- Furman University
- Bob Jones University Sacred Art Museum
- Carolina Fist Center
- BMW Performance Driving Experience
- BMW Zentrum Center
- Greenville Zoo

Hyatt Regency Greenville

ROOM DIMENSIONS & CAPACITIES



Room name

Room name	Room Dimensions Length x Width x Height	Square Feet	Banquet	Reception	Theater	Classroom	Boardroom	U-Shape	Hollow Square
FIRST FLOOR (LOBBY LEVEL)									
GRAND REGENCY BALLROOM	197' x 73' x 14'	14,381	1,200	1,400	1,500	950	—	—	—
CONTINENTAL BALLROOM	72' x 73' x 14'	5,256	350	450	480	250	—	—	—
REGENCY BALLROOM	125' x 73' x 14'	9,125	760	1,000	1,100	600	—	—	—
SECTION A	53' x 73' x 14'	3,869	320	380	430	250	—	—	—
SECTIONS A, B, B2	72' x 73' x 14'	5,256	410	520	550	405	—	—	—
SECTIONS A, B, B2, C, C2	89' x 73' x 14'	6,497	480	640	700	513	—	—	—
SECTIONS B & C	36' x 48' x 14'	1,728	120	170	180	108	—	47	58
SECTIONS B, B2, C, C2	36' x 73' x 14'	2,628	200	260	250	180	—	—	—
SECTION D OR E OR F	35' x 24' x 14'	840	60	80	90	40	—	26	34
SECTIONS D & E OR E & F	35' x 48' x 14'	1,680	120	160	160	108	—	60	84
SECTIONS F, C2	53' x 25' x 14'	1,325	90	130	130	54	—	42	52
SECTIONS D, E, F	35' x 73' x 14'	2,555	180	250	250	180	—	—	—
SECTIONS F, C2, B2	71' x 25' x 14'	1,775	130	170	160	90	—	—	—
SECTIONS D, E, C, B	72' x 48' x 14'	3,456	240	340	340	243	—	—	—
SECTIONS C, C2, D, E, F	53' x 73' x 14'	3,869	290	380	422	270	—	—	—
SECTIONS B, B2, C, C2, D, E, F	72' x 73' x 14'	5,256	420	520	550	405	—	—	—
CREPE MYRTLE ROOM	28' x 25' x 9'	950	70	80	100	40	20	30	36
BOARDROOM	—	567	—	—	—	—	16	—	—
AZALEA SUITE	34' x 16' x 9'	496	20	30	35	18	16	21	24
AZALEA A OR B	16' x 16' x 9'	256	10	10	15	—	6	—	—
GARDENIA SUITE	31' x 21' x 9'	651	30	50	50	30	20	21	24
GARDENIA A OR B	15' x 21' x 9'	315	15	20	25	15	10	—	—
MAGNOLIA SUITE	31' x 20' x 9'	620	50	40	50	30	20	21	24
MAGNOLIA A OR B	15' x 20' x 9'	300	30	20	30	—	10	—	—
DOGWOOD SUITE	28' x 24' x 9'	672	40	40	50	24	20	20	24
DOGWOOD A OR B	14' x 24' x 9'	366	30	20	30	—	10	—	—
REDBUD SUITE	23' x 62' x 9'	1,426	110	140	150	60	—	48	54
REDBUD A OR B OR C	23' x 21' x 9'	483	30	45	50	20	15	15	18
REDBUD A & B OR B & C	23' x 42' x 9'	966	80	80	100	48	20	30	36
SECOND FLOOR									
TEAL SUITE	40' x 90' x 9'	3,600+	200	350	200	140+	—	—	—

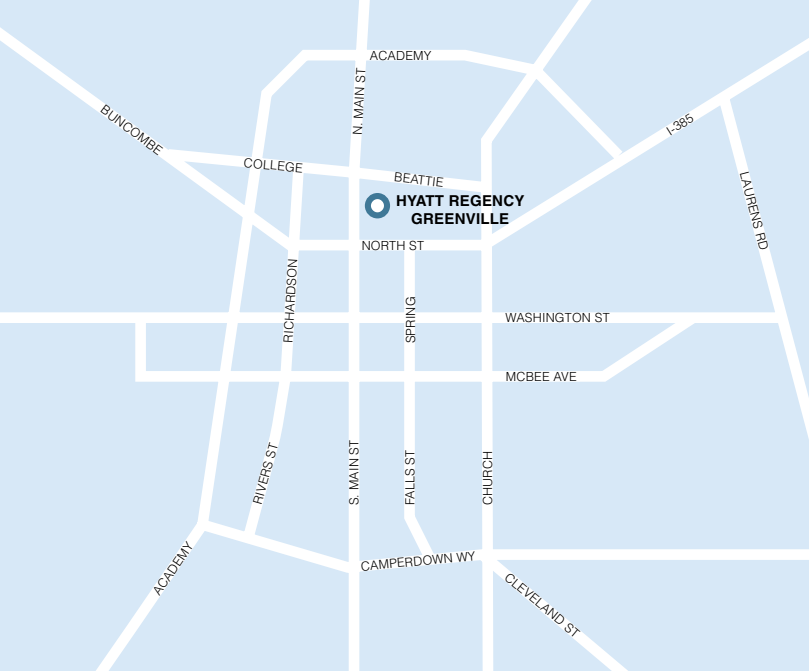

Hyatt Regency Greenville

DIRECTIONS

From Greenville Spartanburg International Airport (14 miles): Take I-85 South to I-385 North. Follow I-385 into downtown. Hotel is at intersection of Beattie Place and Main Street. Hotel driveway is on left.

FIRST FLOOR

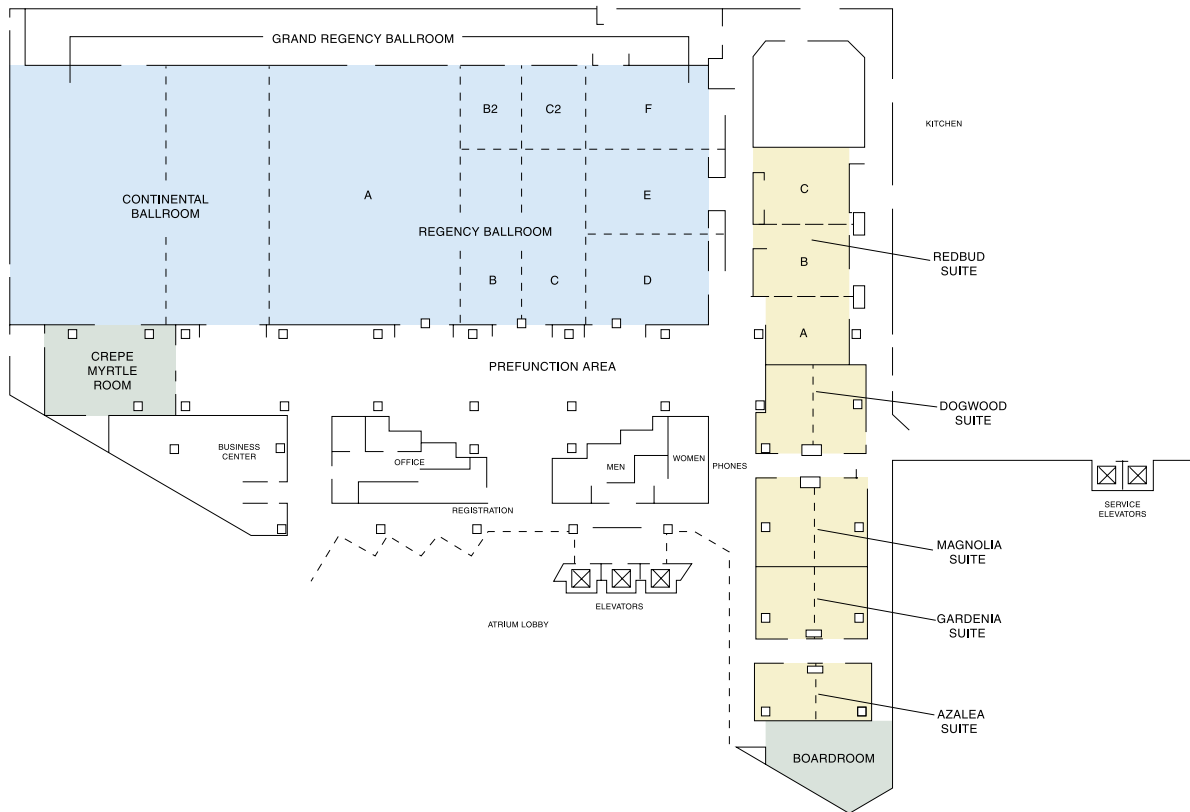

SECOND FLOOR

